

FAG

**6009-H**

Deep groove ball bearing

Schaeffler ID:  
0938823780000Deep groove ball bearing 60..-H, single  
row, H-Series, steel sheet metal cage

## Technical information

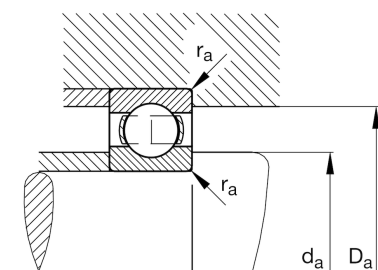
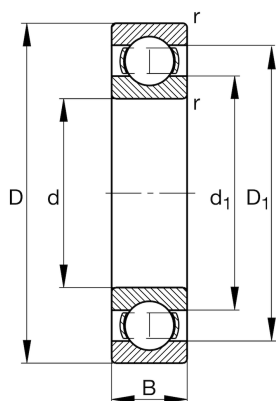
**Main Dimensions & Performance Data**

d	45 mm	Bore diameter
D	75 mm	Outside diameter
B	16 mm	Width
$C_r$	19.890 N	Basic dynamic load rating, radial
$C_{0r}$	13.990 N	Basic static load rating, radial
$C_{ur}$	830 N	Fatigue load limit, radial
$n_G$	13.100 1/min	Limiting speed
$n_{gr}$	9.800 1/min	Reference speed
	0,247 kg	Weight

**Dimensions**

$r_{min}$	1 mm	Minimum chamfer dimension
$D_1$	65,7 mm	Shoulder diameter outer ring
$d_1$	54,3 mm	Shoulder diameter inner ring

**Mounting dimensions**

$d_{a min}$	49,6 mm	Minimum diameter shaft shoulder
$D_{a max}$	70,4 mm	Maximum diameter of housing shoulder
$r_{a max}$	1 mm	Maximum fillet radius

**Calculation factors**

$f_0$	15,3	Calculation factor
-------	------	--------------------

**Temperature range**

$T_{min}$	-30 °C	Operating temperature min.
$T_{max}$	120 °C	Operating temperature max.